

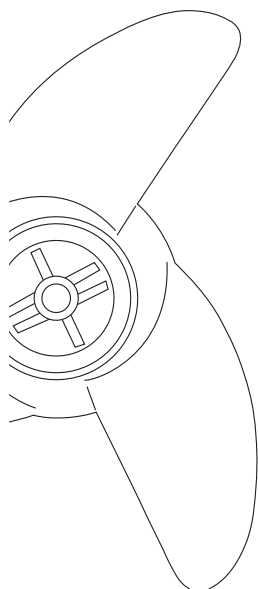

MotorGuide®

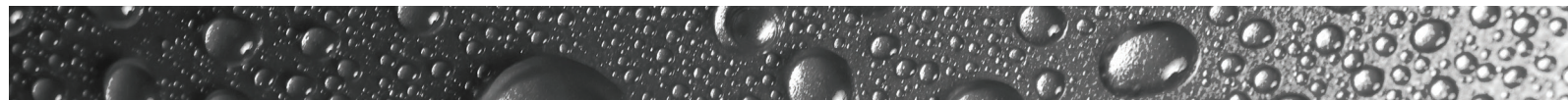



The trolling-motor story is **MotorGuide**

It began in the US back in the 60's, when an inventive angler named G.H.Harris came up with the idea. There were small electric motors at the time, but they were awkward to use and had to be steered by hand. Harris developed the forerunner of today's sophisticated MotorGuide models, with a motor that would move the boat along at fishing speeds, and was easy to operate by foot... leaving the hands free to continue fishing. Over the years, **MotorGuide has simply set the standard** in product innovation, precision engineering, outstanding performance and reliability.

Today around the world, MotorGuide is recognised for its **uncompromising quality** in trolling motors – by both experienced competition anglers and serious amateurs.

10 POWERFUL ADVANTAGES of MotorGuide

- 1. 50 Years of Leadership**
The digital trolling motor breakthrough is exclusive to MotorGuide, the most trusted name in electric trolling motors for more than 50 years.
- 2. Superior materials**
MotorGuide trolling motors have built a reputation for durability by using only carefully-selected metal, alloy and composite materials for all components. You won't find any cheap plastics in a MotorGuide motor!
- 3. Peace-of-mind Service Back-up**
MotorGuide trolling motors are backed by a service support from our network of dealers.
- 4. Digital module is fully protected from the elements**
The MotorGuide digital system is housed in a completely sealed module in a waterproof epoxy pod, that is fully protected from heat, moisture intrusion, corrosion and shock (Fresh and Saltwater models).
- 5. Runs cooler and longer**
MotorGuide digital motors run significantly cooler and longer than analog designs.
- 6. Less amps required, less battery stress**
The motors feature a micro switch that operates on substantially less amperage than conventional motors, for far less stress and strain on the battery.
- 7. Greater efficiency and a longer motor life**
The control module is located in the trolling motor's lower unit, to provide maximum energy efficiency and a more consistent flow of electric current.
- 8. Sustained battery life for more fishing time**
MotorGuide's legendary variable speed efficiency means sustained battery life and more time on the water.
- 9. Virtually eliminates sonar interference**
Digital's clearer, crisper analysis and control of signals, eliminates many of the wires, transistors and high-current switches, responsible for sonar interference in analog motors.
- 10. Quieter, smoother operation**
The variable speed operation is so smooth and quiet, it lets you get closer to the fish.

R3 SERIES

DURABILITY MEETS AFFORDABILITY.

The R3 Transom mount is the ultimate in strength, rigidity and durability. The aluminum alloy construction and stainless steel hinge pins make it one of the most powerful and durable trolling motors available. A classic 5 speeds forward/2 speeds reverse controls and reversible motor head create a dependable yet versatile motor. Put the control at your fingertips with the R3's ergonomic extending handle and a durable multi-position angle adjustment aluminum mount.



INDUSTRY-LEADING TRANSOM MOUNT

The R3 transom mount features aluminum alloy construction with a rugged powder coat finish. Stainless hinge pins provide the ultimate in strength, rigidity and durability. Includes an easy-to-use tilt/stow/deploy mechanism and swing over knobs on the clamp screws, allowing you to lock the motor to the transom.

Hand Operated R3 Transom Mount Series

Model	Model #	Peak Thrust	Shaft	Volts	Speed Control	Mount Style
R3-30 HT	940100070	30 lbs/13.61 kg	30" (76cm)	12	Hand 5-Speed	Aluminium - Transom
R3-40 HT	940100020	40 lbs/18.14 kg	36" (91cm)	12	Hand 5-Speed	Aluminium - Transom
R3-45 HT	940100030	45 lbs/20.41 kg	36" (91cm)	12	Hand 5-Speed	Aluminium - Transom
R3-55 HT	940100050	55 lbs/24.95 kg	36" (91cm)	12	Hand 5-Speed	Aluminium - Transom

- ✓ Freshwater use
- ✓ Aluminum shaft

FEATURES

- 5 speeds forward & 2 reverse
- Reversible motor head for bow or transom mount operation
- Ergonomic, extending handle puts control at your fingertips
- Taper-Lock Mount with 7-point adjustment
- Aluminum shaft provides strength and durability
- Solid aluminum and steel lower unit with powder coat finish
- Stainless steel propeller shaft and 3-blade Machete prop
- Quiet operation lets you get closer to the fish
- Powerful, 3.5" lower unit runs cooler and lasts longer
- One-touch, rapid slide-depth adjustment collar



*Twist tiller operation –
5 speeds forward & 2 reverse*

WHEN THEY'RE **STEPPING OFF** THE WATER, DIGITAL IS JUST GETTING **WARMED UP.**

We never stop advancing technology. Our latest breakthrough, VariMAX™, boasts best-in-class run time and precise variable speed control, so you can stay on the water longer. Perfect for casual rides to all-day fishing trips, VariMAX delivers over 3x the battery life of traditional 5-speed motors. It makes you a more versatile fisherman with its wide range of speed options, and it's one of the quietest motors out there. Check your BluVis™ display to monitor speed and battery voltage. Then, hit the water with the confidence that comes with owning what is perhaps the most durable trolling motor ever. MotorGuide Digital.



NEVER GET STRANDED WITH THE BLUVIS™ FUNCTION DISPLAY.

BluVis shows direction, precise speed settings and 10 levels of battery voltage when turned off. (BluVis 24-volt motor example shown below.)

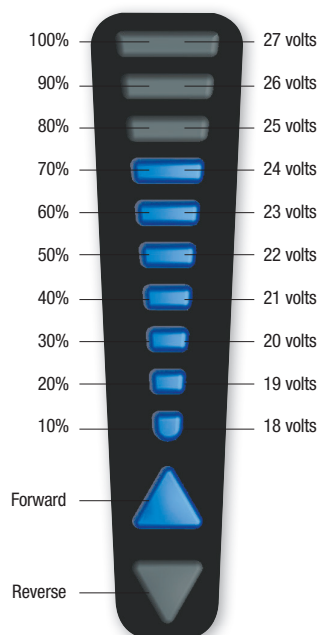

As the handle is rotated, the speed of the motor is shown by the BluVis display in 10% increments.

Motor is operating at 70% in this illustration.

Indicates motor direction



When motor is turned off, the BluVis display shows battery voltage level for 3 seconds.

12-volts remaining in this illustration of a 12-volt battery (13.5-volts fully charged).



Hand Operated VariMAX Transom Mount Series

Model	Model #	Peak Thrust	Shaft	Volts	Speed Control	Mount Style
VARI MAX V40 HT 30" 12V 09	966000010	40 lbs/18.14 kg	30" (76cm)	12	Hand Variable	Aluminium - Transom
VARI MAX V40 HT 36" 12V 09	966000020	40 lbs/18.14 kg	36" (91cm)	12	Hand Variable	Aluminium - Transom
VARI MAX V45 HT 36" 12V 09	966000030	45 lbs/20.41 kg	36" (91cm)	12	Hand Variable	Aluminium - Transom
VARI MAX V45 HT 42" 12V 09	966000040	45 lbs/20.41 kg	42" (107cm)	12	Hand Variable	Aluminium - Transom
VARI MAX V55 HT 36" 12V 09	966000050	55 lbs/24.95 kg	36" (91cm)	12	Hand Variable	Aluminium - Transom
VARI MAX V55 HT 42" 12V 09	966000060	55 lbs/24.95 kg	42" (107cm)	12	Hand Variable	Aluminium - Transom
VARI MAX V75 HT 42" 24V 09	966000070	75 lbs/34.02 kg	42" (107cm)	24	Hand Variable	Aluminium - Transom

- ✓ Freshwater use
- ✓ Equipped with battery indicator
- ✓ Aluminum shaft

Bow and transom mount SERIES

No matter where you fish, there's a foot operated bow or transom mount Series motor that will take you from daylight to dark.

A proven performer gets even better, with the addition of The Digital Advantage – only from MotorGuide.

Every variable-speed model features the ‘Digital Guardian’ speed control. Say goodbye to the hassles of analog and say hello to the exclusive MotorGuide Digital Advantage. Easily the longest-lasting motor you'll ever own!

Foot Operated Bow and Transom Mount Series

Model	Model #	Peak Thrust	Shaft	Volts	Speed Control	Mount Style
FW46FB 36" 12V FLEXMT	921310110	46 lbs/20.87 kg	36" (91cm)	12	Foot Variable	Aluminium - Bow
FW46FB 42" 12V FLEXMT	921310120	47 lbs/21.32 kg	42" (107cm)	12	Foot Variable	Aluminium - Bow
FW54FB 42" 12V FLEXMT	921310160	54 lbs/24.49 kg	42" (107cm)	12	Foot Variable	Aluminium - Bow
FW54FB 50" 12V FLEXMT	921310170	54 lbs/24.49 kg	50" (127cm)	12	Foot Variable	Aluminium - Bow
FW75 FB 50" 24V 20.8MT	921310450	75 lbs/34.02 kg	50" (127cm)	24	Foot Variable	Aluminium - Bow
BULLDOG 40 30" 03	921500020	40 lbs/18.14 kg	30" (76cm)	12	Foot Variable	Aluminium - Transom

- ✓ Freshwater use
- ✓ Aluminum shaft

Foot Operated Bow Mount Tour Series

Model	Model #	Peak Thrust	Shaft	Volts	Speed Control	Mount Style
TR82L FBD 50 24V 21MT	930011030	82 lbs/37.19 kg	50" (127cm)	24	Foot Variable	Aluminium - Bow
TR82L FBD 60 24V 24MT	930011040	82 lbs/37.19 kg	60" (152cm)	24	Foot Variable	Aluminium - Bow

- ✓ Freshwater use
- ✓ Equipped with sonar
- ✓ Stainless steel shaft



- **12 and 24 volt power options**
- **Digital Guardian speed control.** Completely sealed, it is protected from heat, moisture, corrosion and shock... greatly improving durability
- **Improved efficiency** results in extended battery life and more time on the water (variable speed models)
- **Quiet, smooth operation** lets you get closer to the fish
- **Go shallower, faster and quieter,** with our tapered hub, 3-blade weed-free Machete III prop, designed by Mercury Propellers
- **Compact,** lightweight lower units
- **MicroSwitch** designed to withstand the demands of harsh, wet tournament conditions

‘Digital GUARDIAN’

MotorGuide's digital breakthrough in trolling motors is further proof that our design engineers are never satisfied with the status quo.

The ‘Digital Guardian’ module is a mini-masterpiece of engineering. In a completely sealed unit, in a protected location, it precisely controls speed and monitors all vital engine components, eliminating the sonar interference commonly associated with analog circuit boards!



MotorGuide

Primary propulsion models

Sailing boat, inflatable, kayak, aluminum, steel, fiberglass or wooden boat, MotorGuide has the right power for primary propulsion.

Dependable digital motors with variable speed settings, forward and reverse rotation, extendable twist tiller handles, robust transom mounts and shaft's length appropriate for your boat's transom height.

A special coating and painting process along with a large sacrificial anode and stainless steel shaft will make these engines suitable for operation in Fresh, brackish and salt water.



Hand Operated Transom Mount Primary Propulsion Series

Model	Model #	Peak Thrust	Shaft	Volts	Speed Control	Mount Style
VARIMAX V45SW HT 18" 12V ¹	966100010	45 lbs/20.41 kg	18" (46cm XS)	12	Hand Variable	Aluminium - Transom
VARIMAX V45SW HT 36" 12V ¹	966100020	45 lbs/20.41 kg	36" (91cm L)	12	Hand Variable	Aluminium - Transom
VARIMAX V55SW HT 36" 12V ¹	966100030	55 lbs/24.95 kg	36" (91cm L)	12	Hand Variable	Aluminium - Transom
SW82 HT V 30" 09SW 69"	-	82 lbs/37.19 kg	30" (76cm S)	24	Hand Variable	Aluminium - Transom
SW82 HT V 36" 09SW 69"	-	82 lbs/37.19 kg	36" (91cm L)	24	Hand Variable	Aluminium - Transom
SW82 HT V 45" 09SW 69"	9CT42KQAX	82 lbs/37.19 kg	45" (114cm XL)	24	Hand Variable	Aluminium - Transom

¹ Equipped with battery indicator

- ✓ Fresh and saltwater use
- ✓ Stainless steel shaft

TWO BATTERY SET-UPS...for greater reliability

Set-up for two battery system for 12-volt in parallel

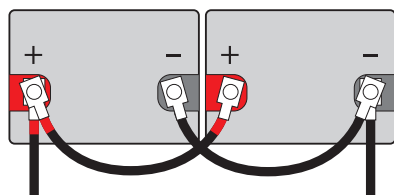

Set-up for two battery system 24-volt series engines

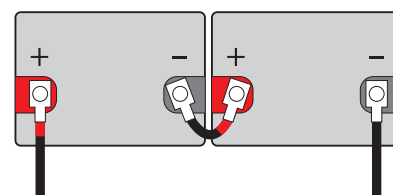

Refer to accessories page for battery options, always consult your MotorGuide Dealer before Installation.

Model	Model #	Peak Thrust	Shaft (inch)	Shaft (cm)	Volts	Speed Control	Mount Style	Note
HAND OPERATED R3 TRANSOM MOUNT SERIES								
R3-30 HT	940100070	30 lbs/13.61 kg	30	76	12	Hand 5-speed	Aluminium - Transom	1 - 5
R3-40 HT	940100020	40 lbs/18.14 kg	36	91	12	Hand 5-speed	Aluminium - Transom	1 - 5
R3-45 HT	940100030	45 lbs/20.41 kg	36	91	12	Hand 5-speed	Aluminium - Transom	1 - 5
R3-55 HT	940100050	55 lbs/24.95 kg	36	91	12	Hand 5-speed	Aluminium - Transom	1 - 5

HAND OPERATED VARIMAX TRANSOM MOUNT SERIES								
VARIMAX V40 HT 30" 12V 09	966000010	40 lbs/18.14 kg	30	76	12	Hand Variable	Aluminium - Transom	1 - 4 - 5
VARIMAX V40 HT 36" 12V 09	966000020	40 lbs/18.14 kg	36	91	12	Hand Variable	Aluminium - Transom	1 - 4 - 5
VARIMAX V45 HT 36" 12V 09	966000030	45 lbs/20.41 kg	36	91	12	Hand Variable	Aluminium - Transom	1 - 4 - 5
VARIMAX V45 HT 42" 12V 09	966000040	45 lbs/20.41 kg	42	107	12	Hand Variable	Aluminium - Transom	1 - 4 - 5
VARIMAX V55 HT 36" 12V 09	966000050	55 lbs/24.95 kg	36	91	12	Hand Variable	Aluminium - Transom	1 - 4 - 5
VARIMAX V55 HT 42" 12V 09	966000060	55 lbs/24.95 kg	42	107	12	Hand Variable	Aluminium - Transom	1 - 4 - 5
VARIMAX V75 HT 42" 24V 09	966000070	75 lbs/34.02 kg	42	107	24	Hand Variable	Aluminium - Transom	1 - 4 - 5

FOOT OPERATED BOW AND TRANSOM MOUNT SERIES								
FW46FB 36" 12V FLEXMT	921310110	46 lbs/20.87 kg	36	91	12	Foot Variable	Aluminium - Bow	1 - 5
FW46FB 42" 12V FLEXMT	921310120	47 lbs/21.32 kg	42	107	12	Foot Variable	Aluminium - Bow	1 - 5
FW54FB 42" 12V FLEXMT	921310160	54 lbs/24.49 kg	42	107	12	Foot Variable	Aluminium - Bow	1 - 5
FW54FB 50" 12V FLEXMT	921310170	54 lbs/24.49 kg	50	127	12	Foot Variable	Aluminium - Bow	1 - 5
FW75 FB 50" 24V 20.8MT	921310450	75 lbs/34.02 kg	50	127	24	Foot Variable	Aluminium - Bow	1 - 5
BULLDOG 40 30" 03	921500020	40 lbs/18.14 kg	30	76	12	Foot Variable	Aluminium - Transom	1 - 5

FOOT OPERATED BOW MOUNT TOUR SERIES								
TR82L FBD 50 24V 21MT	930011030	82 lbs/37.19 kg	50	127	24	Foot Variable	Aluminium - Bow	1 - 3 - 6
TR82L FBD 60 24V 24MT	930011040	82 lbs/37.19 kg	60	152	24	Foot Variable	Aluminium - Bow	1 - 3 - 6

HAND OPERATED TRANSOM MOUNT PRIMARY PROPULSION SERIES								
VARIMAX V45SW HT 18" 12V	966100010	45 lbs/20.41 kg	18	46 extra short	12	Hand Variable	Aluminium - Transom	2 - 4 - 6
VARIMAX V45SW HT 36" 12V	966100020	45 lbs/20.41 kg	36	91 long	12	Hand Variable	Aluminium - Transom	2 - 4 - 6
VARIMAX V55SW HT 36" 12V	966100030	55 lbs/24.95 kg	36	91 long	12	Hand Variable	Aluminium - Transom	2 - 4 - 6
SW82 HT V 30" 09SW 69"	-	82 lbs/37.19 kg	30	76 short	24	Hand Variable	Aluminium - Transom	2 - 6
SW82 HT V 36" 09SW 69"	-	82 lbs/37.19 kg	36	91 long	24	Hand Variable	Aluminium - Transom	2 - 6
SW82 HT V 45" 09SW 69"	9C742KOAX	82 lbs/37.19 kg	45	114 extra long	24	Hand Variable	Aluminium - Transom	2 - 6

NOTE

- Note 1 - Freshwater use
 Note 2 - Fresh and saltwater use
 Note 3 - Equipped with sonar
 Note 4 - Equipped with battery indicator
 Note 5 - Aluminum shaft
 Note 6 - Stainless steel shaft

Model offering and specifications are subject to change without notification.

These models are not available in each area.

Peak thrust ratings are benchmarked in a static tank with voltage applied to the brushes. Motor thrust ratings are benchmarked using a metal propeller.



MotorGuide
NEVER STOP.

Accessories

MotorGuide Replacement Props

Prop	Description	Model #
#10	3" Ninja™, 2 Blade Power Prop	MGA0476
#12	3 1/2" Ninja, 2 Blade Power Prop	MGA0495
#15	3 1/2" Machete, 3 Blade Metal	MGA087M
#16	3 1/2" Machete III, 3 Blade	MGA089B
-	3 1/2" Hydrilla Hacker, 3 Blade	MGA502A1



Ninja Prop Wrench MGA050B6

Comes complete with spare prop nut and two prop pins, allowing fast prop changes.

Optima® Marine Deep Cycle Battery 4,2 L (55 Amps)

67-886561



Optima Marine Cranking & Deep Cycle Battery 5,5 L (75 Amps)

67-886562



Heavy-duty 12-volt deep cycle marine batteries designed for the rigorous demands of professional and sports fishermen with features like rapid recharge, getting you back on the water faster. Power that will last up to 2 times longer than conventional batteries, and a non-spillable, maintenance free design for hassle free use for the life of the battery.

Optima is a trademark of Johnson Controls, Inc.

Sacrificial Anode MAR00203



Attaches to shaft of all motors to give added corrosion protection.

Tour Series 200-kHz Sonar adapters



LOWRANCE (6-Pin)
8M4001959



VEXILAR (3-Pin)
8M4001960



GARMIN (6-Pin)
8M4001961



HUMMINBIRD (7-Pin)
8M4001962

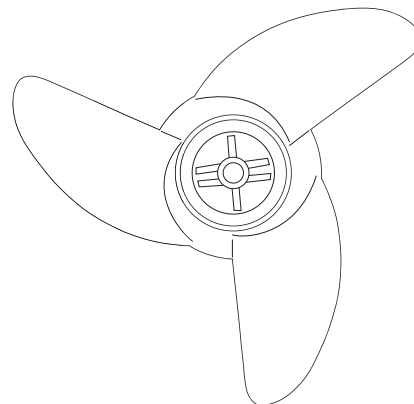

MotorGuide®

NEVER STOP.

BRUNSWICK
Marine in EMEA

© 2012 Brunswick Marine in EMEA. All Rights Reserved. Printed in Belgium. Part #: 90-8M0074653
Brunswick Marine in EMEA continuously explores means to improve the products it designs, manufactures and distributes. Every effort is made to produce sales and service literature which is current. Changes to specifications of engines, boats and accessories are ongoing.
This brochure should not be regarded as a precise guide to the latest specifications. This brochure is also not an offer for sales of any particular engine, boat or accessory. Distributors and dealers are not agents of Brunswick Marine in EMEA or one of its affiliates and they have no authority to bind Brunswick Marine in EMEA by any express undertaking or representation, including but not limited to representations of product, sales, applications or service nature. Not all products are available in all countries and some are available only in limited quantities.
For more information, please see your local dealer. Visit www.brunswick-marine.com

Quality
BRUNSWICK MARINE in EMEA
ISO 9001 - 2000 CERTIFIED
The quality system of
Brunswick Marine in EMEA
is ISO 9001:2000 certified