



TM

2007

MotorGuide®

www.marinepower.com



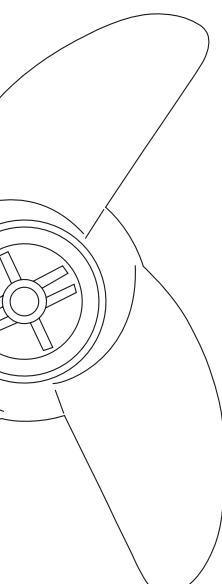

Thruster transom mount series

Power, performance, robustness, reliability...it's all there in the MotorGuide Thruster transom mount series.

They suit virtually any fishing application and are designed to run quietly, and run cool...so important, as the cooler the operation, the longer your battery and motor life. Heat build-up also creates the vibration and noise that spooks the fish. With a Thruster transom mount trolling motor the fish just don't hear you coming.

Loads of thrust for your money. That defines the all-new Thruster Series. With four 12-volt transom models – providing up to 54 pounds (24.5 kg) of thrust. Both feature the all-metal mount and five forward speeds/two reverse.



Thruster Transom Mounted

Model	Thrust (kg / Lb)	Volts	Speed Control	Shaft (cm)	Steering style
T30	13.6/30	12	5	76	Twist-Tiller
T36	16.3/36	12	5	76	Twist-Tiller
T46	20.9/46	12	5	76	Twist-Tiller
T54	24.5/54	12	5	91	Twist-Tiller



The trolling-motor story is **MotorGuide**

It began in the US back in the 60's, when an inventive angler named G.H.Harris came up with the idea. There were small electric motors at the time, but they were awkward to use and had to be steered by hand.

Harris developed the forerunner of today's sophisticated MotorGuide models, with a motor that would move the boat along at fishing speeds, and was easy to operate by foot... leaving the hands free to continue fishing.

Over the years, **MotorGuide has simply set the standard** in product innovation, precision engineering, outstanding performance and reliability.

Today around the world, MotorGuide is recognised for its **uncompromising quality** in trolling motors – by both experienced competition anglers and serious amateurs.

DIGITAL

12 POWERFUL ADVANTAGES of MotorGuide

1. **40 Years of Leadership**

The digital trolling motor breakthrough is exclusive to MotorGuide, the most trusted name in electric trolling motors for more than 40 years

2. **Superior materials**

MotorGuide trolling motors have built a reputation for durability by using only carefully-selected metal, alloy and composite materials for all components. You won't find any cheap plastics in a MotorGuide motor!

3. **Peace-of-mind Service Back-up**

MotorGuide trolling motors are backed by a service support from our network of dealers

4. **Digital module is fully protected from the elements**

The new MotorGuide digital system is housed in a completely sealed module in a waterproof epoxy pod, that is fully protected from heat, moisture intrusion, corrosion and shock (Fresh and Saltwater models)

5. **Runs cooler and longer**

MotorGuide digital motors run significantly cooler and longer than analog designs

6. **Less amps required, less battery stress**

The motors feature a new micro switch that operates on substantially less amperage than conventional motors, for far less stress and strain on the battery

7. **Greater efficiency and a longer motor life**

The control module is located in the trolling motor's lower unit, to provide maximum energy efficiency and a more consistent flow of electric current

8. **Sustained battery life for more fishing time**

MotorGuide's legendary variable speed efficiency means sustained battery life and more time on the water

9. **Virtually eliminates sonar interference**

Digital's clearer, crisper analysis and control of signals, eliminates many of the wires, transistors and high-current switches, responsible for sonar interference in analog motors

10. **Quieter, smoother operation**

The variable speed operation is so smooth and quiet, it lets you get closer to the fish

11. **Self-regulating for durability**

MotorGuide digital motors are self-regulating, for more durable operation and an extended service life

12. **Greater serviceability**

MotorGuide digitals are designed with 'plug-in' service modules, that greatly improve serviceability

'Digital GUARDIAN'

MotorGuide's digital breakthrough in trolling motors is further proof that our design engineers are never satisfied with the status quo.

The 'Digital Guardian' module is a mini-masterpiece of engineering. In a completely sealed unit, in a protected location, it precisely controls speed and monitors all vital engine components, eliminating the sonar interference commonly associated with analog circuit boards!

MotorGuide goes digital, and trolling motors will never be the same!

We have all become used to digital technology, in such things as mobile phones, home entertainment and in fact, most advanced electronic components.

But now, digital has arrived to the world of fishing!

As it has done so often over the last 40 years, **MotorGuide leads the way** once again, with this vastly improved technology in electric trolling motors. By incorporating digital technology, MotorGuide now offers variable-speed trolling motors with **dramatic improvements in performance, reliability, capability and serviceability!**

This digital revolution is really what the MotorGuide brand is all about. We believe there are some things you should never stop doing...

Based on Simplicity, Built for Durability!

Like most brilliant engineering and electronic advancements, **MotorGuide's patent protected Digital Guardian system simply does the job more efficiently.** Going digital means more than just better performance, it's also all about improved reliability, and when it comes to trolling motors, only MotorGuide has it.

Digital Guardian monitors the motor's amp draw, heat dissipation, output and other vital parameters. The result is a motor that self regulates – a cooler, quieter, more efficient running motor over an extended life. Serviceability is also greatly improved via 'plug-in' modules.

Digital Guardian is standard in variable speed Great White® and Freshwater motors. Add MotorGuide's many other innovations, such as our patented 'breakaway' mount design, and you have

trolling motors that are simply safer, and more efficient.

Whatever the conditions, from a fast-running coastal tide, to inland waters full of snags and grass, MotorGuide trolling motors simply keep on performing day in, day out!



TWO BATTERY SET-UPS...for greater reliability

Set-up for two battery system for 12-volt in parallel

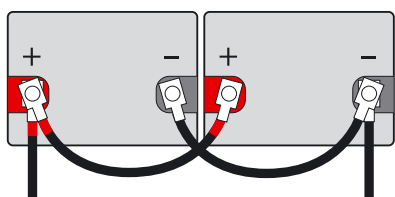

Set-up for two battery system 24-volt series engines

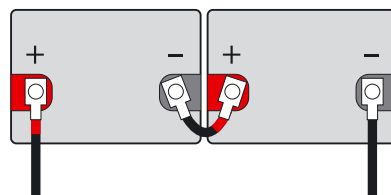

Refer to accessories page for battery options, always consult your MotorGuide Dealer before Installation.



Freshwater SERIES

No matter where you fish, there's a Freshwater Series motor that will take you from daylight to dark.

This year, a proven performer gets even better, with the addition of The Digital Advantage – only from MotorGuide.

Now every variable-speed model features the 'Digital Guardian' speed control. Say goodbye to the hassles of analog and say hello to the exclusive MotorGuide Digital Advantage. Easily the longest-lasting motor you'll ever own!

- ▶ **From 30 to 82 pounds of thrust** with 12 and 24 volt power options
- ▶ **Variable speed models** feature Digital Guardian speed control. Completely sealed, it is protected from heat, moisture, corrosion and shock... greatly improving durability
- ▶ **Improved efficiency** results in extended battery life and more time on the water (variable speed models)
- ▶ **Quiet, smooth operation** lets you get closer to the fish
- ▶ **Go shallower, faster and quieter**, with our all-new tapered hub, 3-blade weed-free Machete III prop, designed by Mercury Propellers
- ▶ **Extending twist-tiller handle on** select hand control models
- ▶ **Compact**, lightweight lower units
- ▶ **New MicroSwitch** designed to withstand the demands of harsh, wet tournament conditions (bow mount models)

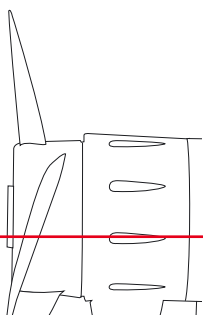

FW 54 FB DIGITAL

Built in the MotorGuide Brute® tradition, the Digital marries legendary MotorGuide durability, with digital technology in a 24-volt, variable-speed package.



FreshWater Bow Mounted - Foot-Operated

	Model	Thrust (kg / Lb)	Volts	Speed Control	Shaft (cm)	Steering style
	FW46FB	20.9/46	12	5	107	Rack & Pinion
	FW54FB	24.5/54	12	5	107	Rack & Pinion

Transom Mount

FW 54 HTV DIGITAL

Sophisticated digital technology meets tough, non-nonsense performance in this 12-volt transom mount package. You get MotorGuide's legendary durability in a motor that keeps on performing wherever the fish are biting.



FreshWater Transom Mounted

	Model	Thrust (kg / Lb)	Volts	Speed Control	Shaft (cm)	Steering style
Digital	FW54HTV	24.5/54	12	Variable	107	Extended Twist-Tiller
	FW82HTV	37.2/82	24	Variable	115	Extended Twist-Tiller
Non Digital	FW30HT	13.6/30	12	5 - 2	76	Twist-Tiller
	FW36HT	16.3/36	12	5 - 2	91	Twist-Tiller
	FW46HT	20.9/46	12	5 - 2	91	Twist-Tiller
	FW54HT	24.5/54	12	5 - 2	91	Extended Twist-Tiller

DIGITAL

Great White[®] SALTWATER Series



Wherever you find the best shallow saltwater fishing, that's where you'll find MotorGuide. No piece of equipment on your boat is better prepared to take on the harsh realities of saltwater, than a MotorGuide Great White.

Never before has a trolling motor been built to better withstand the rigors of heat, corrosion and current.

These 'Great Whites' certainly have teeth. Built for long-days fishing, they tame the corrosive effects of saltwater. With an ultra-pure, aluminium coating on the centre housing, a consistent electrical potential is achieved... forming a mechanical and chemical barrier to galvanic corrosion. And now the Great White Series offers you all the advantages of Digital, in an iron-clad unit made for extreme conditions. Next time you're facing stiff headwinds and hull-pounding swells, make sure you choose the motor that defined saltwater performance – MotorGuide Great Whites...now with the Digital Advantage.

- ▶ **Digital power from 46 to 54 pounds of thrust**
- ▶ **Ultra-pure aluminium coating** "self-heals" from scratches, providing added protection in abrasive shallow water use
- ▶ **Stainless steel shaft**, fasteners and control cables
- ▶ **Anodized aluminium mounts** and components prevent galvanic corrosion
- ▶ **Machete III Prop** is quieter and has a smaller diameter than two-blade designs, for ultimate shallow water performance

Maximum Corrosion Protection

- ▶ New multi-step lower unit coating process includes 99.9% pure AlumiPlate coating, under zinc free epoxy powder primer.
- ▶ Polyester top-coat protects against dings and scratches.
- ▶ Dual sacrificial anodes provide the ultimate galvanic corrosion protection.
- ▶ Industry's only stainless steel shaft... long proven in harsh saltwater environments.
- ▶ No exposed electronics in the head. Great White 'Digital Guardian' is epoxy-coated and fully sealed in the waterproof lower unit.
- ▶ Anodized aircraft-aluminium mounts, with stainless components.

SaltWater Great White Tansom Mount

	Model	Thrust (kg / Lb)	Volts	Speed Control	Shaft (cm)	Steering style
	SW46HT	20.9/46	12	5 - 2	91	Twist-Tiller
Digital	SW54HT	24.5/54	12	Variable	107	Extended Twist-Tiller



Hand Tiller DIGITAL SERIES

The most popular series in our saltwater lineup. Great White hand-bow models now with Digital Guardian, so there are no exposed electronics in the head, greatly increasing reliability.



Specifications for models available in Europe, C.I.S. and Africa – Middle East markets

MotorGuide
NEVER STOP.

MotorGuide

FreshWater Transom Mounted

Model	Part Number	Weight (kg)	Thrust (kg / Lb)	Volts	Speed Control	Shaft (cm)	Shaft Material	Steering Control	Steering style	Transducers	Propellers	Mount Style	Maximum Boat Weight Recommended
FW30HT	921210061	6.10	13.6/30	12	5 - 2	76	stainless steel	Hand	Twist-Tiller	No	Power Prop (2)	#03 Transom	1,000 kg
FW36HT	921210051	7.80	16.3/36	12	5 - 2	91	stainless steel	Hand	Twist-Tiller	No	Machete (3)	#03 Transom	1,200 kg
FW48HT	921210041	9.00	20.9/46	12	5 - 2	91	stainless steel	Hand	Twist-Tiller	No	Machete (3)	#09 Transom Wide bite	1,500 kg
FW54HT	921210031	9.40	24.5/54	12	5 - 2	91	stainless steel	Hand	Extended Twist-Tiller	No	Machete (3)	#09 Transom Wide bite	1,800 kg
FW54HTV	9CC31KQAF	11.40	24.5/54	12	Variable	107	stainless steel	Hand	Extended Twist-Tiller	No	Machete (3)	#09 Transom Wide bite	1,800 kg
FW82HTV	9CT32KQCF	11.80	37.2/82	24	Variable	115	stainless steel	Hand	Extended Twist-Tiller	No	Machete (3)	#09 Transom Wide bite	2,700 kg

FreshWater Bow Mounted - Foot-Operated

Model	Part Number	Weight (kg)	Thrust (kg / Lb)	Volts	Speed Control	Shaft (cm)	Shaft Material	Steering Control	Steering style	Transducers	Propellers	Mount Style	Maximum Boat Weight Recommended
FW46FB	921310110	14.80	20.9/46	12	5	107	stainless steel	Foot	Rack & Pinion	No	Machete (3)	#16 Breakaway	1,500 kg
FW54FB	921310160	16.00	24.5/54	12	5	107	stainless steel	Foot	Rack & Pinion	No	Machete (3)	#16 Breakaway	1,800 kg

Thruster

Transom Mounted

Model	Part Number	Weight (kg)	Thrust (kg / Lb)	Volts	Speed Control	Shaft (cm)	Shaft Material	Steering Control	Steering style	Transducers	Propellers	Mount Style	Maximum Boat Weight Recommended
T30	960010030	6.10	13.6/30	12	5 - 2	76	Aluminum	Hand	Twist-Tiller	No	Power Prop (2)	#03 Transom	1,000 kg
T36	960010020	7.00	16.3/36	12	5 - 2	76	Aluminum	Hand	Twist-Tiller	No	Machete (3)	#03 Transom	1,200 kg
T46	960010070	7.00	20.9/46	12	5 - 2	76	Aluminum	Hand	Twist-Tiller	No	Machete (3)	#03 Transom	1,500 kg
T54	960010050	9.00	24.5/54	12	5 - 2	91	Aluminum	Hand	Twist-Tiller	No	Machete (3)	#03 Transom	1,800 kg

MotorGuide

SaltWater Great White Transom Mount

Model	Part Number	Weight (kg)	Thrust (kg / Lb)	Volts	Speed Control	Shaft (cm)	Shaft Material	Steering Control	Steering style	Transducers	Propellers	Mount Style	Maximum Boat Weight Recommended
SW46HT	9DE21KQAX	9.20	20.9/46	12	5 - 2	91	stainless steel	Hand	Twist-Tiller	No	Machete (3)	#09 Transom Wide bite SW	1,500 kg
SW54HT	9CC31KQAX	9.60	24.5/54	12	Variable	107	stainless steel	Hand	Extended Twist-Tiller	No	Machete (3)	#09 Transom Wide bite SW	1,800 kg

Peak thrust ratings are benchmarked in a static tank with voltage applied to the brushes. Motor thrust ratings are benchmarked using a metal propeller. Model offerings and specifications are subject to change without notification.

Accessories

MotorGuide Replacement Props

Prop	Description	Number
#10	3" Ninja™, 2 Blade Power Prop	MGA0476
#12	3 1/2" Ninja, 2 Blade Power Prop	MGA0495
#15	3 1/2" Machete, 3 Blade Metal	MGA087X6
#16	3 1/2" Machete III, 3 Blade	MGA089X1
-	3 1/2" Hydrilla Hacker, 3 Blade	MGA502A1



Optima® Marine Deep Cycle Battery 4,2 L (55 Amps)

67-886561



Optima Marine Cranking & Deep Cycle Battery 5,5 L (75 Amps)

67-886562

Heavy-duty 12-volt deep cycle marine batteries designed for the rigorous demands of professional and sports fishermen with features like rapid recharge, getting you back on the water faster. Power that will last up to 2 times longer than conventional batteries, and a non-spillable, maintenance free design for hassle free use for the life of the battery.



Optima is a trademark of Johnson Controls, Inc.

Ninja Prop Wrench

MGA050B6

Comes complete with spare prop nut and two prop pins, allowing fast prop changes.



Sacrificial Anode

MAR002-03

Attaches to shaft of all motors to give added corrosion protection.

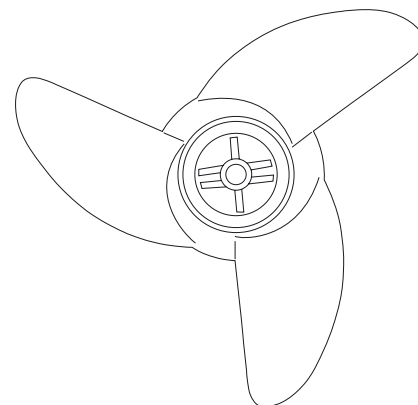

MotorGuide®
NEVER STOP.

